

171-16-020A Residential Parcel

This is a residential parcel located at [5525 N CAMELBACK CANYON DR PHOENIX 85018](#). and the current owner is 5525 L L C. It is located in the Valhalla subdivision and MCR 2312. It was last sold on 03/01/2001 for \$700,000. Its current year full cash value is \$3,779,700.

Property Information[5525 N CAMELBACK CANYON DR PHOENIX 85018](#)

MCR # [2312](#)
 Description: CAMELBACK HTS LOT 20 EX BEG AT MOST SLY COR SD LOT TH NWLY ALG SWLY LI 15.02' TH NELY 15' TH SELY 15' TH SWLY ALG SELY LI 15.25' TO POB
 Lat/Long [33.51761944](#) | [-111.98110611](#)
 Lot Size 49,807 sq ft.
 Zoning RE-24
 Lot # 20
 High School District SCOTTSDALE UNIFIED #48
 Elementary School District SCOTTSDALE UNIFIED SCHOOL DISTRICT
 Local Jurisdiction PHOENIX
 S/T/R 18 2N 4E
 Market Area/Neighborhood 05/005
 Subdivision (5 Parcels) [VALHALLA](#)

Owner Information[5525 L L C](#)

Mailing Address 2375 E CAMELBACK RD STE 700, PHOENIX, AZ 85016
 In Care Of GHELFI CAPITAL INVESTMENTS
 Deed Number [010353589](#)
 Last Deed Date 04/30/2001
 Sale Date Mar, 2001
 Sale Price \$700,000

Valuation Information

We provide valuation information for the past 5 years. For mobile display, we only show 1 year of valuation information. Should you need more data, please look at our [data sales](#).

The Valuation Information displayed below may not reflect the taxable value used on the tax bill due to any special valuation relief program. [CLICK HERE TO PAY YOUR TAXES OR VIEW YOUR TAX BILL](#)

Tax Year	2021	2020	2019	2018	2017
Full Cash Value	\$3,779,700	\$3,237,300	\$3,467,800	\$2,870,100	\$3,532,200
Limited Property Value	\$3,322,499	\$3,164,285	\$3,013,605	\$2,870,100	\$3,532,200
Legal Class	4.1	4.1	4.1	4.1	4.1
Description	NON-PRIMARY/NOT IN OTHER CLASSES RESID	NON-PRIMARY/NOT IN OTHER CLASSES RESID	NON-PRIMARY/NOT IN OTHER CLASSES RESID	NON-PRIMARY/NOT IN OTHER CLASSES RESID	NON-PRIMARY/NOT IN OTHER CLASSES RESID
Assessment Ratio	10%	10%	10%	10%	10%
Assessed LPV	\$332,250	\$316,429	\$301,361	\$287,010	\$353,220
Property Use Code	0171	0171	0171	0171	0171
PU Description	Single Family Residence	Single Family Residence	Single Family Residence	Single Family Residence	Single Family Residence
Tax Area Code	481300	481300	481300	481300	481300
Valuation Source	Notice	Notice	Notice	Notice	Notice

Additional Property Information

Additional residential property data.

Construction Year 2005
 Weighted Age 2005
 Improvement Quality R-7 (Superior)
 Pool Yes
 Living Area 10,365 sq ft.
 Patio(s) Covered: 0 | Uncovered: 0
 Exterior Wall Type Brick
 Roof Type Built Up
 Bath Fixtures 23
 Garage Stalls 2
 Carport Stalls
 Locational Characteristics Mountain

Building Sketches

Sketches that illustrate the external dimensions of a property.

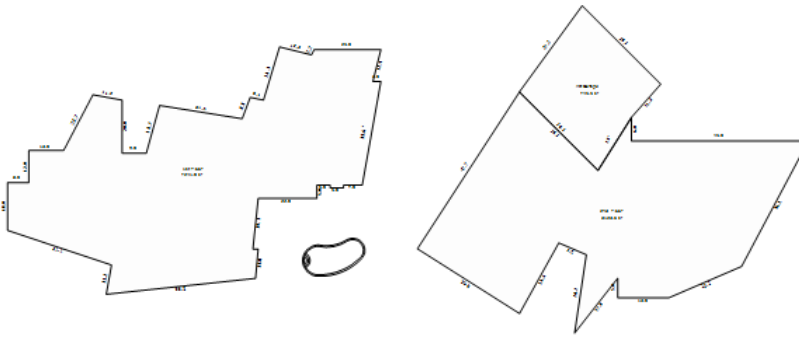

Similar Parcels

Parcels that are similar to this one (known as the reference parcel) are displayed below.

APN	Address	Sale Info	FCV	Size	Livable Sq Ft	Year Built	Pool	Foreclosed
173-46-007A	6415 E EXETER BLVD SCOTTSDALE, AZ 85251	\$6,000,000/01-2016	\$3,636,300	41,208	8,483	2008		